



Fabricant de **catalyseurs** et **filtres à particules**

FRANÇAIS

AUDI, SEAT, VOLKSWAGEN

**37946**



PK931



1740



7.87



Euro  
5

Réf. Original:

1K0254511JX, 1K0254512BX, 1K0254513NX

MARQUE	MODÈLE	DATE
AUDI	A3 Cabrio 1.8i TFSI 16V 1798 cc 118 Kw / 160 cv CDAA	1/09>5/13
AUDI	A3 2.0i TFSI 16V 1984 cc 147 Kw / 200 cv CCZA	7/08>3/13
SEAT	ALTEA 2.0i TFSI 16V 1984 cc 155 Kw / 211 cv CCZB	3/09>9/15
SEAT	LEON 2.0i TFSI 16V 1984 cc 155 Kw / 211 cv CCZB	6/09>9/13
<b>VOLKSWAGEN</b>	<b>EOS 2.0i TFSI 16V 1984 cc 147 Kw / 200 cv CCZA</b>	<b>9/08&gt;7/15</b>
<b>VOLKSWAGEN</b>	<b>EOS 2.0i TFSI 16V 1984 cc 155 Kw / 211 cv CCZB</b>	<b>9/08&gt;7/15</b>
<b>VOLKSWAGEN</b>	<b>GOLF VI 1.8i TFSI 16V 1798 cc 118 Kw / 160 cv CDAA</b>	<b>6/09&gt;8/13</b>
<b>VOLKSWAGEN</b>	<b>GOLF VI 2.0i TFSI 16V 1984 cc 147 Kw / 200 cv CCZA</b>	<b>7/09&gt;8/13</b>
<b>VOLKSWAGEN</b>	<b>GOLF VI 2.0i TFSI 16V 1984 cc 155 Kw / 211 cv CCZB</b>	<b>4/09&gt;8/13</b>
<b>VOLKSWAGEN</b>	<b>JETTA 2.0i TFSI 16V 1984 cc 147 Kw / 200 cv CCZA</b>	<b>10/10&gt;7/14</b>
<b>VOLKSWAGEN</b>	<b>NEW BEETLE 2.0i TFSI 16V 1984 cc 147 Kw / 200 cv CCZA</b>	<b>12/10&gt;7/16</b>
<b>VOLKSWAGEN</b>	<b>SCIROCCO 2.0i TFSI 16V 1984 cc 155 Kw / 211 cv CCZB</b>	<b>9/09&gt;9/16</b>

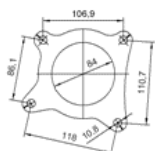

Ø 59,8 ext

