



Manufacturer of **catalytic converters** and **particulate filters**

ENGLISH

FORD

**20456D**



PK1150



700



4.00



Euro  
5

OE

1681480, 1706906, 1728766, 1755322

| MAKE | MODEL  | DATE       |
|------|--|------------|
| FORD | GALAXY 2.0TD TDCI DPF 1997 cc 85 Kw / 116 cv KLWA, TYWA              | 3/10>4/15  |
| FORD | GALAXY 2.0TD TDCI DPF 1997 cc 100 Kw / 136 cv UKWA                   | 3/10>4/15  |
| FORD | GALAXY 2.0TD TDCI DPF 1997 cc 103 Kw / 140 cv UFWA                   | 3/10>4/15  |
| FORD | GALAXY 2.0TD TDCI DPF 1997 cc 120 Kw / 163 cv TXWA                   | 3/10>4/15  |
| FORD | <b>MONDEO 2.0TD TDCI DPF 1997 cc 85 Kw / 116 cv KLBA, LPBA, TYBA</b> | 3/10>12/14 |
| FORD | MONDEO 2.0TD TDCI DPF 1997 cc 100 Kw / 136 cv UKBA, UKBB             | 3/10>12/14 |
| FORD | MONDEO 2.0TD TDCI DPF 1997 cc 103 Kw / 140 cv UFBA, UFBB             | 3/10>12/14 |
| FORD | MONDEO 2.0TD TDCI DPF 1997 cc 120 Kw / 163 cv TXBA, TXBB             | 3/10>12/14 |
| FORD | S-MAX 2.0TD TDCI DPF 1997 cc 85 Kw / 116 cv KLWA, TYWA               | 3/10>4/15  |
| FORD | S-MAX 2.0TD TDCI DPF 1997 cc 100 Kw / 136 cv UKWA                    | 3/10>4/15  |
| FORD | S-MAX 2.0TD TDCI DPF 1997 cc 103 Kw / 140 cv UFWA                    | 3/10>4/15  |
| FORD | S-MAX 2.0TD TDCI DPF 1997 cc 120 Kw / 163 cv TXWA                    | 3/10>4/15  |

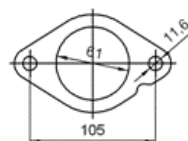

Ø 66x90°

