



Hersteller von **Katalysatoren** und **Partikelfiltern**

DEUTSCH

BMW

45243



PK809



2200



11.00

Original-Artikelnummer:

18307511648, 18307521989, 18307523730, 18307525551

| MARKE | MODELL | DATUM |
|-------|--|-------------|
| BMW | 316i 1.6i 16V 1596 cc 85 Kw / 116 cv N40B16A, N45B16A (N42, N45) E46 | 6/02>7/06 |
| BMW | 316i Ti Compact 1.6i 16V 1596 cc 85 Kw / 116 cv N40B16A, N45B16A (N42, N45) | 6/02>2/05 |
| BMW | 316i 1.8i 16V 1796 cc 85 Kw / 116 cv N42B18A, N46B18A (N42, N46) E46 | 12/02>2/05 |
| BMW | 316i Ti Compact 1.8i 16V 1796 cc 85 Kw / 116 cv N42B18A, N46B18A (N42, N46) | 12/02>2/05 |
| BMW | 318i 2.0i 16V 1995 cc 100 Kw / 136 cv N42B20A, N46B20A (N42, N46) E46 | 12/02>12/06 |
| BMW | 318i Ti Compact 2.0i 16V 1995 cc 100 Kw / 136 cv N42B20A, N46B20A (N42, N46) | 12/02>12/04 |
| BMW | 318i 2.0i 16V 1995 cc 105 Kw / 143 cv N42B20A, N46B20A, N46B20C (N42, N46) | 12/02>12/06 |
| BMW | 318i Ti Compact 2.0i 16V 1995 cc 105 Kw / 143 cv N42B20A, N46B20A (N42, N46) | 12/02>2/05 |
| BMW | 318i 2.0i 16V 1995 cc 110 Kw / 150 cv N46B20A, N46B20C (N46) E46 | 3/04>8/06 |

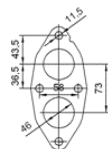

Ø 49,8 ext.